

TYPE SIN 010



ISTRUZIONI PER L'USO
OPERATING INSTRUCTIONS
MODE D'EMPLOI
BEDIENUNGSANLEITUNG
INSTRUCCIONES DE USO
INSTRUÇÕES PARA USO
GEBRUIKSAANWIJZING

PER LA VOSTRA SICUREZZA LEGGERE ATTENTAMENTE LE ISTRUZIONI PER L'USO.
FOR YOUR SAFETY CAREFULLY READ THE OPERATING INSTRUCTIONS.
POUR VOTRE SÉCURITÉ, LISEZ SOIGNEUSEMENT LES INSTRUCTIONS D'EMPLOI.
FÜR IHRE SICHERHEIT LESEN SIE BITTE SORGFÄLTIG DIE BEDIENUNGSANLEITUNG,
BEVOR SIE DAS GERÄT IN BETRIEB SETZEN.
PARA SU SEGURIDAD, LÉALAS ATENTAMENTE.
PARA A SUA SEGURANÇA DEVE LER ATENTAMENTE ESTAS INSTRUÇÕES.
LEES DEZE GEBRUIKSAANWIJZING ZORGVULDIG VOORDAT U DE MACHINE GEBRUIKT.

FOR HOUSEHOLD USE ONLY 

Congratulazioni,

Ci congratuliamo con voi per l'acquisto di questa macchina per caffè espresso, di qualità superiore, e vi ringraziamo per la fiducia accordataci. Prima di mettere in funzione la macchina, vi consigliamo di leggere attentamente le istruzioni per l'uso che vi spiegano come utilizzarla, pulirla e mantenerla in perfetta efficienza. Se avete altre domande, rivolgetevi al rivenditore o direttamente alla nostra casa. Saremo lieti di darVi tutti i chiarimenti desiderati.

Congratulations,

Congratulations on choosing this top-quality espresso machine and many thanks for your confidence in our products. Before operating the machine, we recommend you read the following instructions thoroughly which explain how to use, clean and maintain the machine. For any other information, please contact the dealer or our company directly. We will be glad to provide you with any explanations you may need.

Félicitations,

Nous vous félicitons de l'achat de cette machine pour café express de qualité supérieure et Vous remercions pour Votre préférence. Avant de mettre la machine en marche, nous Vous recommandons de lire attentivement ces instructions d'emploi qui expliquent comment employer, nettoyer et conserver la machine en parfait état de fonctionnement. Si Vous avez des questions à poser, nous Vous prions de contacter le détaillant ou directement notre maison. Nous Vous donnerons avec plaisir toutes les informations nécessaires.

Wir gratulieren Ihnen Kauf dieser Espressomaschine höchster Qualität und danken Ihnen für Ihr Vertrauen. Vor der Inbetriebnahme der Maschine empfehlen wir, diese Bedienungsanleitung sorgfältig durchzulesen, die Anweisungen über den Gebrauch, die Reinigung und die Pflege der Maschine gibt. Wenn Sie weitere Fragen haben, werden Sie sich bitte an den Händler oder direkt an uns. Wir werden Ihnen gerne alle notwendigen Erklärungen geben.

Felicidades!

Congratulándonos con Ud por haber comprado esta máquina para café expreso, de calidad superior, Le agradecemos la confianza depositada en nuestros productos. Antes de poner en marcha el aparato Le aconsejamos lea atentamente las instrucciones de empleo que explican como utilizarla, limpiarla y mantenerla correctamente. En caso tenga más cuestiones, acuda al revendedor o directamente a nuestra casa. Será un placer darle las informaciones deseadas.

Parabens!

Està do parabéns pela aquisição desta máquina de café espresso, de qualidade superior e agradecemos a confiança demonstrada. Antes de utilizar a máquina é aconselhável ler atentamente o manual de instruções na qual lhe explicamos como utilizá-la, limpá-la e mantê-la perfeitas condições. No caso de ter qualquer outras questões é aconselhável contactar o revendedor ou directamente o fabricante. Estaremos ao v/ dispor para todos os esclarecimentos desejados.

Gefeliciteerd!

Wij feliciteren u met het feit dat u dit espresso-apparaat van topkwaliteit gekocht heeft en wij danken u voor het in ons gestelde vertrouwen. Voordat u het apparaat in gebruik neemt adviseren wij u deze gebruiksaanwijzing aandachtig te lezen. In deze gebruiksaanwijzing wordt namelijk uitgelegd hoe u het apparaat het beste kunt gebruiken, schoonmaken en onderhouden zodat het apparaat lang meegaat.

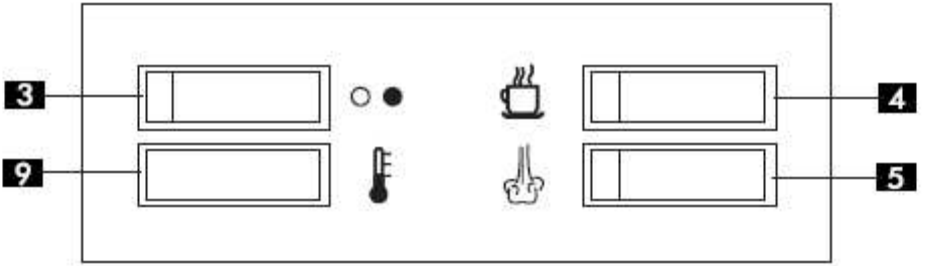
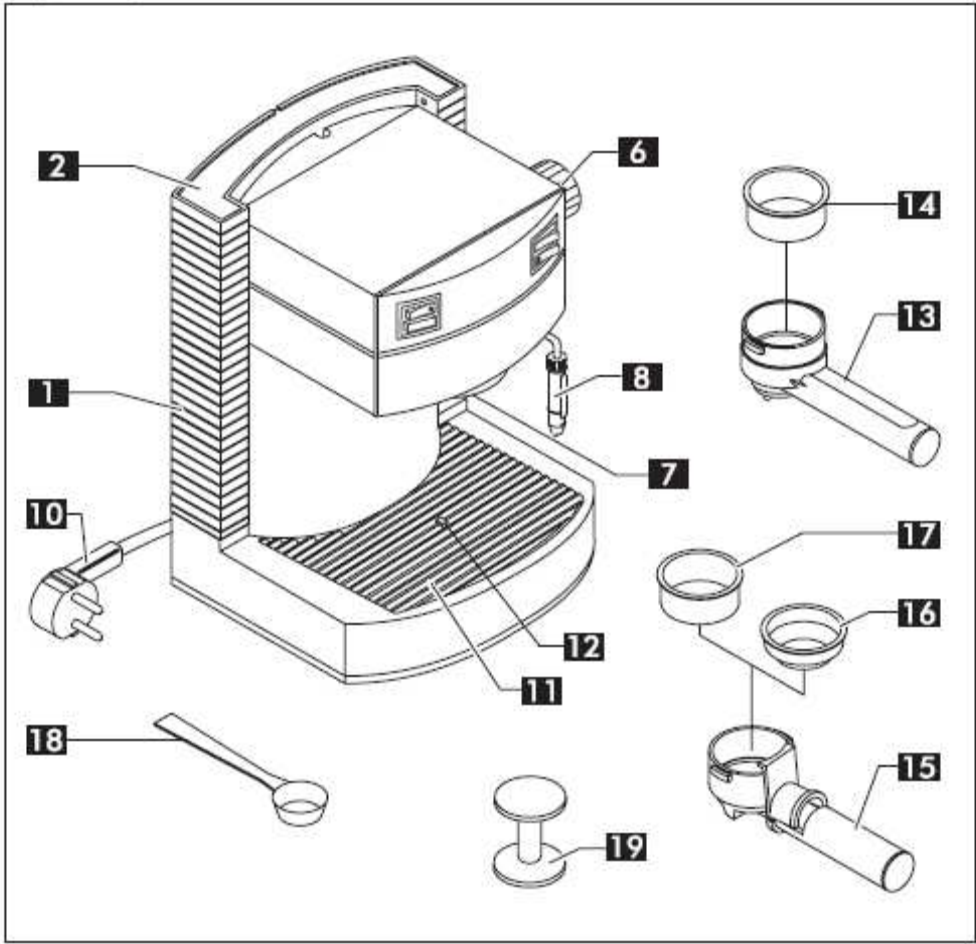

20

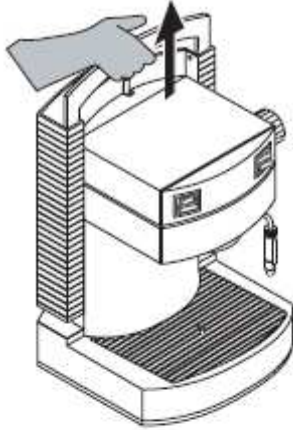

21

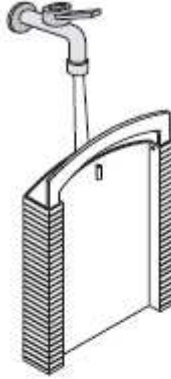

22



23

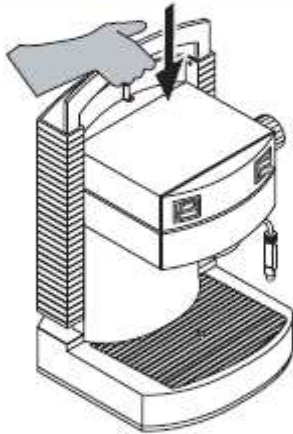

24



25

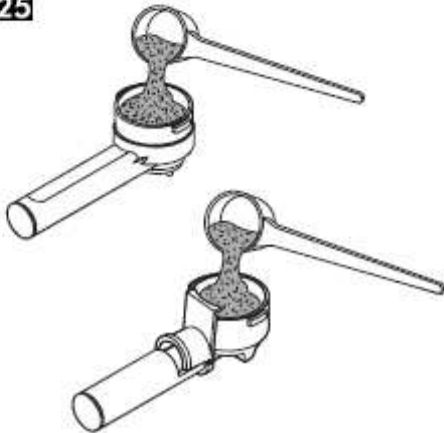

26

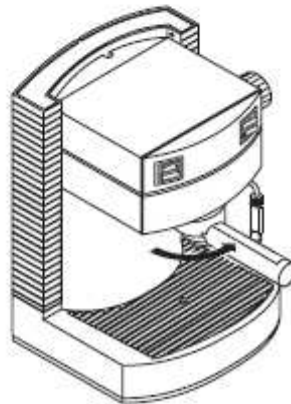

27

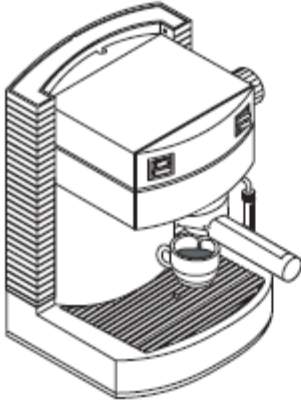

28

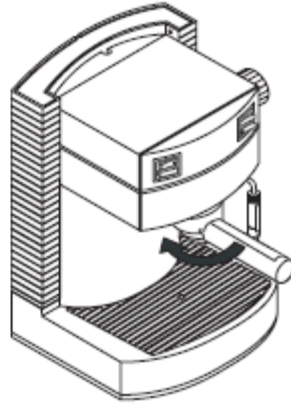

29

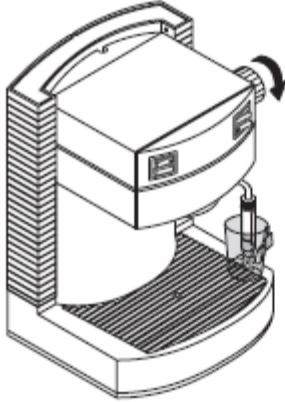

30

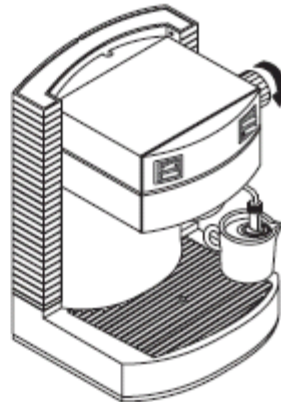

31



32

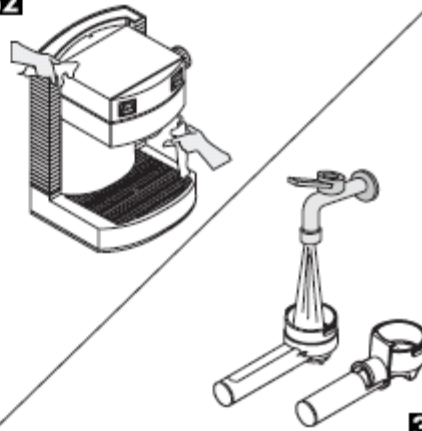

33

Contents

1 GENERAL	18	5 COFFEE FLOW	24
1.1 Guide to the instructions	18	5.1 Using the "Crema" filter holder	24
1.2 How to use these instructions	19	5.2 Using the brass filter holder	24
2 TECHNICAL SPECIFICATIONS	19	6 ADVICE ON CHOICE OF COFFEE	25
3 SAFETY REGULATIONS	21	7 HOT WATER JET	25
4 INSTALLATION	23	8 HOW TO PREPARE A CAPPUCCINO	26
4.1 Packaging	23	COFFEE USING THE STEAM TUBE	26
4.2 Installment requirements	23	9 CLEANING INSTRUCTIONS	26
4.3 Connecting the appliance to the power		10 DESCALING	26
supply	23	11 SERVICING	27
4.4 Filling the water tank	23	12 LEGAL INFORMATION	27
4.5 Priming	23	13 DISPOSAL OF THE APPLIANCE	28
		14 TROUBLESHOOTING	29

1 GENERAL

This coffee machine is designed to make 1 or 2 cups of espresso coffee, and includes an adjustable hot water/steam tube.

The switches on the front of the machine are clearly labelled with easy to understand symbols.

The machine is elegantly designed for a domestic kitchen and is not suitable for heavy duty, professional use.

Warning: The manufacturers accept no responsibility for eventual faults caused by any of the following:

- Misuse or use contrary to the manufacturer's recommendations;
- Repairs attempted by persons not belonging to an authorised service centre;
- Mishandling of the mains cable;
- Mishandling of any part of the machine;
- Use of unauthorised spare parts or accessories.

In any of the above cases the guarantee will prove null and void.

1.1 Guide to the instructions



The warning triangle indicates all the personal safety instructions. Follow these instructions carefully to avoid injury.

i This symbol indicates the most important information for ensuring an optimal use of the machine.

B References to diagrams, parts of the appliance or control switches etc. are indicated by a number or letter. Keep the illustrations to hand.



The diagrams referred to in the leaflet are placed in the inside cover flap.
Keep these pages open while reading the instructions.

1.2 How to use these instructions

Keep the instructions in a safe place or attach them to the machine for easy consultation by others.

If you desire any further information or have a problem not sufficiently covered by this leaflet please contact our qualified experts.

2 TECHNICAL SPECIFICATIONS

Rated voltage	See rating plate on appliance
Rated output	See rating plate on appliance
Body material	Thermo-formed plastic
Dimensions (l x h x w)	245 x 310 x 250
Weight	4 kg
Cable length	1.2 m
Control panel	Frontal
Filter holder (depending on model)	"Crema" Brass
"Pannarello"	Cappuccino optional extra
Tank	Removable
Power supply	See rating plate
Water tank	2 l
Pump pressure	13-15 bar
Boiler	Stainless steel
Safety requirements	Pressure safety valve in boiler Safety thermostat

The manufacturer reserves the right to change the make up of the machine in the light of any technological breakthrough.

The machine complies to the European Standard 89/336/EEC (legislative decree 476 04.12.92), referring to the elimination of broadcasting disturbance.

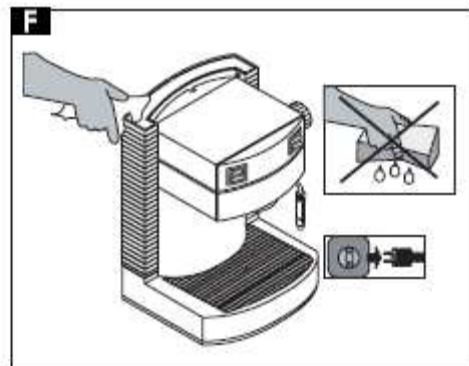
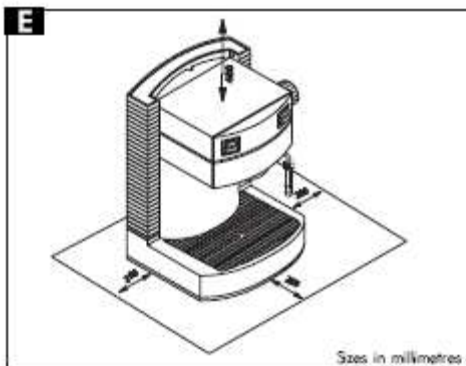
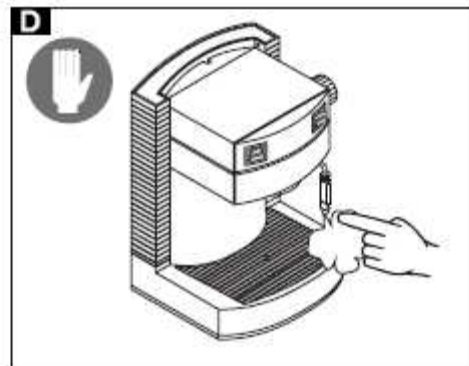
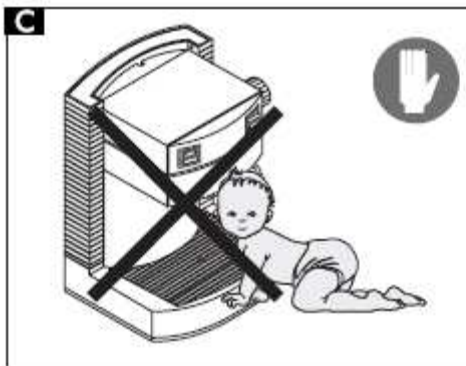
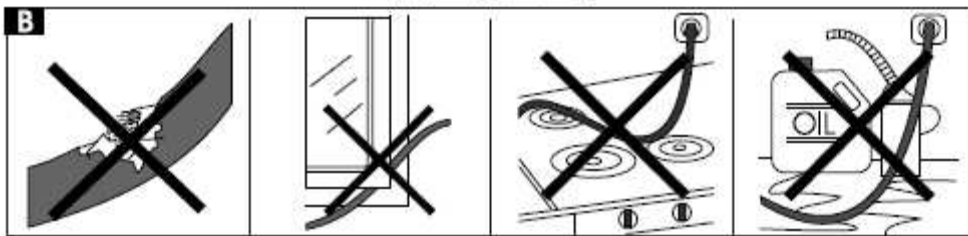
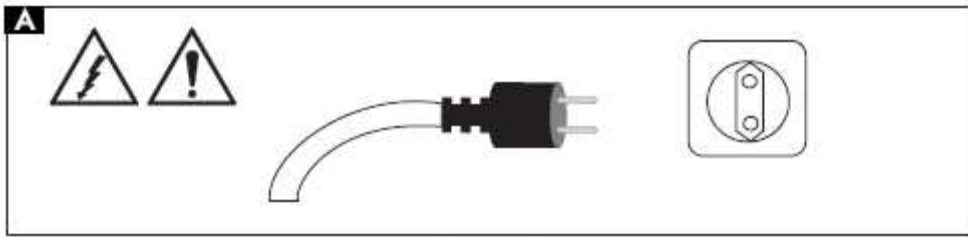

3 SAFETY REGULATIONS



All electrical parts must be kept dry, as the machine may short circuit on contact with water. Steam and boiling water can cause burning. Always point the steam or hot water jet away from any part of the body and be careful when touching the steam/hot water nozzle as it may be hot: danger of burning.

Use of machine

The machine must not be used for anything other than its intended purpose.

The coffee machine is designed exclusively for domestic use.

Technical alterations or misuse are strictly forbidden owing to the risks that they involve.

The coffee maker must be used by adults only.

A Electrical requirements

The coffee machine must be connected to a suitable wall socket.

The voltage used must be that indicated on the rating plate.

B Mains cable

The coffee maker must not be used if the mains cable flex is defective.

If a plug or cable is defective it must be changed immediately by a qualified specialist.

Do not locate the mains cable over hot surfaces or round sharp corners and keep it away from oil.

Do not carry or pull the machine by the mains cable.

Do not unplug the machine by pulling the

mains cable or with wet hands.

Do not allow the flex to dangle from a shelf or table.

C Safeguarding others

Ensure that the machine is out of the reach of children.

Children are not aware of the risks involved in electrical appliances.

Packing materials must not be left within children's reach as they represent a potential source of danger.

D Burning precautions

Always point the steam/hot water jet away from you.

Always use the correct handles or knobs.

Only touch the nozzle in the part where it has been insulated for your protection.

Do not remove the filter holder while the machine is in use.

While the machine is warming up, hot water may drip from the coffee outlet.

E Location

The machine must be positioned in a safe place where it cannot be knocked over or cause injury.

Hot water or steam may leak, causing possible burning.

Do not use the coffee machine outdoors.

Do not place the machine near hot surfaces or naked flames as this may damage or melt the cover.

F Cleaning Instructions

Before cleaning the machine, all switches must be in the "off" position, and the machine must be unplugged from the wall socket. You must wait for the machine to cool down. Never immerse the machine in water. It is strictly forbidden to tamper with the inside of the machine.

E Recommended space for use and maintenance

To get the best results from the coffee machine, the following is recommended:

- Place the machine on a flat, even surface;
- Choose a position that is well-lit, hygienic and where a wall socket is easily accessible;
- Check that the minimum distances around the machine are as indicated in the diagram.

Storage of the machine

If the machine is to be left unused for a long period, turn it off and unplug it from the wall socket. Keep in a dry place, out of the reach of children. Protect from dirt and dust.

Repairs/Maintenance

If the machine stops working, is in any way defective or has been knocked over unplug it immediately from the wall socket.

Never use a faulty machine.

Repairs or alterations must only be carried out by qualified experts.

Repairs or alterations must only be carried out by an authorised service centre.

The company will accept no responsibility for damage caused by repairs attempted by unauthorised persons.

Fire risks

Should the machine catch fire, use a carbon dioxide extinguisher. Do not use water or a powder extinguisher.

Legend of machine components

- 1** Water tank
- 2** Water tank lid
- 3** Main switch
- 4** Coffee switch
- 5** Steam switch
- 6** Steam/hot water knob
- 7** Coffee outlet
- 8** Steam tube
- 9** Machine on light
- 10** Mains cable
- 11** Drip tray + grill

Accessories (the accessories vary depending on the model)

- 12** Full tray warning light
- 13** "Crema" filter holder
- 14** Filter for "Crema" filter holder
(A single unit for making 1 or 2 cups of coffee)
- 15** Brass filter holder
- 16** Single cup filter for brass filter holder
- 17** Twin cup filter for brass filter holder
- 18** Coffee measure
- 19** Press

4 INSTALLATION

For personal safety follow the "Safety regulations" found on Par.3.

4.1 Packaging

The original packaging has been designed to protect the appliance during transportation.

You are recommended to keep it for later use.

4.2 Installment requirements

Before installing the machine read the following safety instructions carefully:

- Locate the machine in a safe place;
- Make sure that it is out of the reach of children;
- Do not place the machine on a hot surface or near a naked flame.

The coffee maker is now ready to be connected.

4.3 Connecting the appliance to the power supply

 Electricity can be dangerous, so always follow the safety regulations carefully.

 Never use a faulty cable. Faulty plugs and cables must be changed immediately by authorised personnel.

The coffee maker must be connected to a suitable wall socket.

The voltage of the appliance has been factory-set.

The voltage on the rating plate (positioned on the bottom of the appliance) must correspond to that of your house electricity supply.

- Uncoil a length of cable from the cable wind found underneath the appliance, sufficient for the plug to reach the wall socket.
- Check that the main switch is in the "0" position before inserting the plug in the wall socket.
- Plug the appliance into a wall socket carrying the correct voltage.

4.4 Filling the water tank

- **20** Open the tank lid (2).
- Lift the water tank (1) by using the lid. The valve on the bottom of the tank will not allow water to flow out.
- **21** Rinse and fill the tank with fresh water without overfilling.
- **23** Put the tank back in its correct position.
- When the tank is in place, press lightly down on it to insert the valve correctly. The valve will open automatically.
- Close the lid on the tank.

 Always fill the tank with fresh, not carbonised water: hot water or other liquids may damage the tank.

 Do not use the coffee maker without water, always check that there is enough water in the tank.

4.5 Priming

24 Before using the machine for the first time, after the appliance has been left unused for a long period or when the water and steam have run out, it is necessary to prime the machine.

- Turn on the main switch (3), the light on the inside will be on.
- Point the steam tube ("Pannarello") over the drip tray.
- Open the "hot water/steam" knob (6), turning it in an anti-clockwise direction

and press the coffee switch (4).

- Wait until a steady stream of water flows from the tube ("Pannarello").
- Press the coffee switch (4) again and close the "hot water/steam" knob (6), turning it in a clockwise direction.

The machine is now ready to make a perfect cup of coffee.

5 COFFEE FLOW

 **Warning!** Do not remove the filter holder by turning it manually in a clockwise direction while the machine is producing coffee. Danger of burning.

- While the machine is working the "machine on" light (9) will go on and off. This is perfectly normal.
- Before using the machine, make sure that the "hot water/steam" knob (6) is closed and that there is sufficient water in the tank.
- Turn on the machine. If the coffee maker is not working the light on the inside of the main switch (3) will light up.
- Wait for the "machine on" light (9) to be on. Now the coffee maker is ready.

 **Note:** we recommend emptying the water tray when the level float (12) rises.

5.1 Using the "Crema" filter holder

- Place the filter (14) inside the "Crema" filter holder (13).
- **26** Fit the "Crema" filter holder into the coffee outlet socket (7), pushing it upwards and turning it to the right until it locks into place.
- Let go of the filter holder handle. Automatically the handle will move slightly to the left. This movement guarantees the perfect functioning of the filter holder.

- **27** Place a cup under the filter holder. To warm up the filter holder and the cup, press the coffee switch (4); water will begin to drip from the filter holder (this operation is only necessary for the first cup of coffee).
- When the cup is sufficiently full, press the coffee switch (4) again.
- **28** Remove the filter holder from the machine by turning it to the left and pour out any water that is left inside.
- With the special "Crema" filter holder (13) supplied with the machine, it is not necessary to change the filter to obtain one or two cups of coffee.
- **25** To make one or two cups of coffee, add 1 or 2 even measures of ground coffee to the filter.
- Clean the edges of the filter holder from any excess of coffee grounds.
- **26** Fit the "Crema" filter holder (13) into the coffee outlet socket (7), as explained before, pushing it upwards and turning it to the right until it locks into place.
- **27** Position two warmed cups under the filter holder, making sure that they are directly under the coffee spouts.
- Press the coffee switch. Wait until the cups are sufficiently filled.
- Press the coffee switch again to stop the coffee flow.
- **28** When the coffee flow has ceased, remove the filter holder and empty out the excess coffee grounds.

 **Cleaning note:** always keep the "Crema" filter holder clean by removing it and washing it with drinking water.

5.2 Using the brass filter holder

- Place the filter (16 or 17, single or twin cup, depending on the number of

coffees you wish to make) in the brass filter holder (15).

- **26** Fit the filter holder into the coffee outlet socket (7), pushing it upwards and turning it to the right until it locks into place.
- **27** Place a cup under the filter holder. To warm up the filter holder and the cup, press the coffee switch (4); water will begin to drip from the filter holder (this operation is only necessary for the first cup of coffee).
- When the cup is sufficiently full, press the coffee switch (4) again.
- **28** Remove the filter holder from the machine by turning it to the left.
- **25** To make one or two cups of coffee, add 1 or 2 even measures of ground coffee to the filter, depending on whether you are using the single or twin cup filter.
- Tamp the coffee down lightly using the press and brush off any excess coffee from the edge of the filter holder.
- **26** Fit the brass filter holder (15) into the coffee outlet socket (7), as explained above, pushing it upwards and turning it to the right until it locks into place.
- **27** Position two warmed cups under the filter holder, making sure that they are directly under the coffee spouts.
- Press the coffee switch. Wait until the cups are sufficiently filled.
- Press the coffee switch again to stop the coffee flow.
- **28** When the coffee flow has ceased, remove the filter holder and empty out the excess coffee grounds.

i Cleaning hint: when cleaning the filter take it right out of the filter holder and rinse thoroughly.

6 ADVICE ON CHOICE OF COFFEE

Practically any type of ground coffee on the market can be used with this machine.

Coffee is a natural product and its taste varies, depending on its origin and blend. It is therefore advisable to try a number of different types to discover your own personal preference. For best results use blends specifically ground for espresso machines. The coffee flow should be constant and should not drip.

The speed of the coffee flow can be regulated by changing the dosage, the fineness of the grinding and/or by how heavily you tamp down the coffee in the filter.

 **BEFORE USING THE HOT WATER/ STEAM JET, MAKE SURE THAT THE STEAM TUBE ("PANNARELLO") IS POSITIONED OVER THE DRIP TRAY.**

7 HOT WATER JET

- If the machine is not already on, turn it on at the main switch (3) which will light up.
- **29** Place a cup or a glass tea cup under the steam tube ("Pannarello").
- Open the "Hot water/steam knob (6), turning it in anti-clockwise direction and press the coffee switch (4) to start the water flow.
- To stop the water flow, press the coffee switch (4) again, and close the steam knob (6) by turning it in a clockwise direction.

 **Danger of burning!** When water begins to flow out, it may be very hot. The steam tube does get very hot, so avoid touching it in any way.

8 HOW TO PREPARE A CAPPUCCINO COFFEE USING THE STEAM TUBE

- If the machine is not already on, turn it on at the main switch (3) which will light up.
- Press the steam switch (5) which will light up. The "machine on" light (9) will turn off.
- When the "machine on" light (9) comes back on, the machine steam tube is ready to use.
- **24** Point the steam tube ("Pannarello") over the drip tray and open the "hot water/steam" knob (6) for a few seconds to clear the tube of any excess water. Wait for a few more seconds for steam to flow out.
- Close the knob (6).
- **30** Immerse the tube in the liquid to be heated and open the knob (6). Move the container gently up and down to ensure that the liquid is heated right through.
- When the liquid has reached the required temperature close the knob (6) and turn off the "steam" switch (5).

i To make a cappuccino heat milk using the method explained above.

- Proceed following the priming instructions found in par. 4.5 to operate the machine.
- When you have finished using the steam tube (pannarello) clean with a damp cloth.

9 CLEANING INSTRUCTIONS

Before cleaning the machine, let it cool down and unplug it.

- Do not immerse the coffee maker in water

and do not put any of the components in a dishwasher.

- Do not use sharp objects or abrasive chemical products (solvents) to clean the machine.
- **21** Clean the water tank and fill it with fresh water daily.
- After heating milk, release a small quantity of hot water to clean out the steam tube and wipe the outside of it with a damp cloth.
- **32** Use a damp cloth to wipe down the appliance.
- **33** Clean the filter holder as follows:
 - Remove the filter, place it in hot water and wash it carefully.
 - Clean the inside of the filter holder.
- Do not dry the machine and/or any of its parts using a microwave and/or conventional oven.
- Clean the "Pannarello" located over the steam tube, if it is fitted on your machine. To do this, unscrew the ring nut, remove the "Pannarello" from the steam tube and take off the external casing. Rinse the "Pannarello" under running water and then put it back together again.



The ring nut must be closed properly as otherwise the "Pannarello" may come loose during use.

10 DESCALING

31 The formation of lime on the inside of the appliance is inevitable.

If you notice a reduction in the water capacity of the appliance it is necessary to descale the machine.



If you wish to descale the appliance yourself, use a descaler

especially made for coffee machines. Use a product normally available on the market, that is neither toxic nor harmful.



Warning! Never use vinegar as a descaler.

- Remove the water container and empty out any remaining water.
- **22** Mix the descaling agent with water as directed on the package and pour the solution into the water container; place the water container inside the machine.
- Turn on the machine by pressing the main switch.
- Position the steam tube over the drip tray.
- **24** Empty the entire contents from the water container at intervals (one cup at a time) by turning the steam knob (6) counterclockwise and pressing the coffee switch (4); to cut off flow press the coffee switch (4) again and turn the steam knob (6) clockwise.
- Every time a cup of descaler is released the machine should be turned off at the main switch (3) and left for 10-15 minutes to give the descaling solution time to act.
- **21** When all the descaling agent has been used up, take out the water container, rinse it out and fill it with fresh drinking water.
- **24** Place the container back inside the machine; empty out 2/3 of the water in the container by turning the steam knob (6) counterclockwise and pressing the coffee switch (4); to cut off flow press the coffee switch (4) again and turn the steam knob (6) clockwise.
- Let the machine heat up and empty out the water remaining in the water container by turning the steam knob (6) counterclockwise and pressing the coffee switch (4); to cut off flow press the coffee

switch (4) again and turn the steam knob (6) clockwise.

i If a descaling product that has not been recommended is used, we do advise the client to follow the manufacturer's instructions found on the packet.

11 SERVICING

Regular servicing carried out by an authorised service centre will prolong the life and efficiency of the machine.

Keep the original packaging as it may prove useful in protecting the machine at a later date.

12 LEGAL INFORMATION

- These instructions include information on how to use the machine correctly, its functions and its maintenance.
- If these instructions are followed closely no risks should be run in using the appliance and all necessary safety requirements regarding function and maintenance should be upheld.
- If more information is required or if a particular problem not dealt with or insufficiently explained in these instructions should arise, the customer should contact his/her local dealer or the manufacturer directly.
- We would also like to bring to the customer's attention that these instructions are not part of any previous or existing convention, agreement or legal contract and hence have no legal bearing.
- The obligations of the manufacturer are based on the relative contract of sale

which includes the complete and exclusive regulation regarding guarantee requirements.

The terms of the guarantee are in no way affected by these instructions.

The instructions contain information protected by copyright laws.

The instructions may not be photocopied or translated into a foreign language without the manufacturer's written permission.

13 DISPOSAL OF THE APPLIANCE

- An appliance that is no longer in use must be rendered unworkable.
 - Remove the plug and cut the mains cable at the base.
 - Take unused appliances to a qualified disposal centre.
-

14 TROUBLESHOOTING

Problem	Possible causes	Solutions
The machine does not work	The machine is not properly connected to the power supply	Connect the machine correctly to the power supply
The pump is too noisy	There is not enough water in the tank (par. 4.4)	Fill up the tank
The coffee is too cold	Ready light was not on when espresso was made.	Wait until the ready light comes on
	The filter holder was not in place while heating up the machine (par. 5.1-5.2)	Warm up the filter holder
The milk does not froth up	You are using the wrong type of milk	Check the fat content of the milk
The coffee flow is too fast, and it does not make a creamy coffee	There is not enough coffee in the filter holder or the coffee is not ground finely enough	Add coffee (par. 5.1-5.2)
	The coffee is old or unsuitable	Try a different blend (chap.6)
The coffee does not flow or only drips	There is not enough water in the machine	Add water (par.4.4)
	The coffee is too finely ground	Change type of coffee
	Coffee is stuck in the filter holder	Loosen it
	There is too much coffee in the filter holder	Scoop some of it out using the coffee measure
	The "Hot water/steam" knob (6) is open	Close it
	The machine needs descaling	Descal it (chap.10)
	The upper filter is blocked	Clean the filter element
Coffee is leaking from the filter edges	The filter in the filter holder is blocked	Clean the filter (chap.9)
	The filter holder has not been fitted correctly into the coffee outlet socket	Insert the filter holder correctly (par.5.1-5.2)
	The top edge of the filter holder is dirty	Clean the edges of the filter holder
	The boiler washer is dirty or worn out	Clean or change the washer
	There is too much coffee in the filter holder	Scoop some of it out using the coffee measure

If you should have a problem that is not dealt with in the above table or is not resolved by any of these solutions please contact an authorised service centre.